

NEMA 6-30P

Angled Plugs



Volex offers two different NEMA 6-30P plugs in straight and angled versions. These products have a maximum rating of 30A at 250V and are all designed and manufactured with UL/c-UL and CSA safety approvals to meet the following standards:

UL 498

UL 817

CSA Std. C22.2



| NEMA 6-30P ANGLED PLUGS | | | |
|-------------------------|------------|--------------------------------|--|
| Standard | | UL 498, UL 817, CSA Std. C22.2 | |
| Max. Rating | | 30A, 250V | |
| Safety Approval | | UL/c-UL, CSA | |
| Catalogue No. | Cable Type | Size | Matching Connector |
| US208A | SPT-3 | 3 x AWG 12 | Free-end or Fast-on and Ring Terminals |
| | NISPT-3 | 3 x AWG 12 | |

NEMA 6-30P PLUGS TECHNICAL INFORMATION

Volex US208A is an angled NEMA 6-30P plug that is typically used with heavy appliances and equipment.

Safety approvals cover two different cable types available:

SPT-3

NISPT-3

Conductor size include AWG 12 with 3 conductors.

This NEMA 6-30P angled plug from Volex is commonly used in North America. See photos, drawings and chart below for details.

NEMA 6-30P PLUGS TECHNICAL DRAWINGS

VS208A

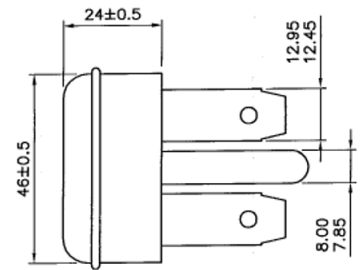
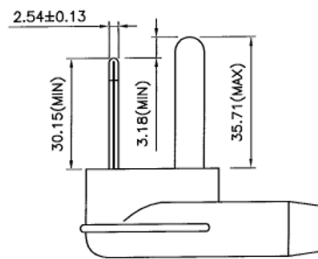
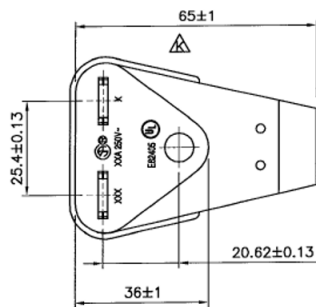

Contact us at sales@volex.com
for assistance in finding the right solution for your needs.